

# MPS Blades mill for solids

## general features



The MPS BLADES MILL is suitable for grinding wet and/or fibrous products such as vegetables or pharmaceutical products with a certain degree of humidity, or for conditioning materials that cannot be processed directly in a micronizer, due to their initial size. This mill allows particle size control, thanks to the incorporation of a static sieve of perforated sheet metal.

Its operating principle is based on particle size reduction through cutting with stainless steel blades.

### FEEDING SYSTEM

This equipment is equipped with a stainless steel tilting tray coupled to a ramp or neck with an appropriate degree of inclination so that the product enters the grinding chamber following a tangential path.

On request, the equipment can be prepared with other feeding systems, such as a vertical inlet (suitable for more fragile materials) or a horizontal using a dosing screw (appropriate when the process requires a uniform and adjustable feed).

If it is necessary to work under temperature or inertisation conditions, optional heating/cooling or nitrogen injection systems can be installed in the inlet neck.

### GRINDING ELEMENTS

It incorporates a set of perfectly machined and balanced stainless steel crushing blades.

Different types of blades are available: single-edged or double-edged (for processes involving cutting or chopping the material); with blunt edge (if pulverizing is needed) or with one edge blunt and the other sharp (if the process requires cutting and pulverizing). Depending on the product to be ground and the desired granulometry, different types of blades will be assembled.



Power supply system prepared for connection to pneumatic conveyor

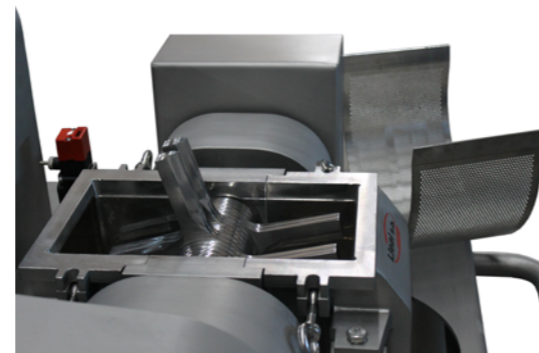

MPS-310 mill where the blades and the sieve design can be observed.



Below the grinding elements, there is a static sieve made of perforated metal plate, interchangeable according to product and fineness.

At the customer's request, it is possible to supply the equipment with a motor drive inverter and blunt-edged blades, enabling the blades to function as hammers.

### ASSEMBLY TABLE

Mobile assembly table for mounting the mill, built in AISI-304 or AISI-316 stainless steel, with a hopper equipped with bagging mouth for bag attachment, motor anchoring base, transmission wheel cover, and the mill's control panel.

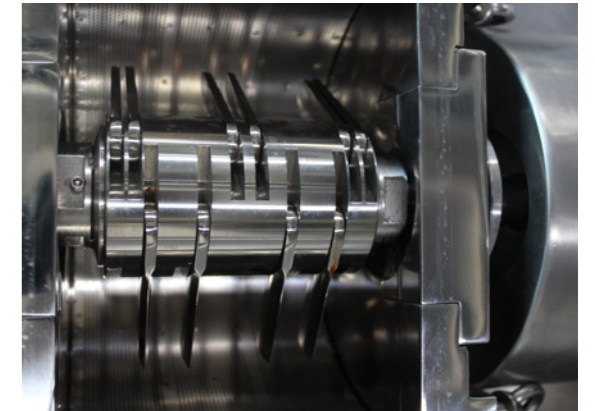

Set of folding blades

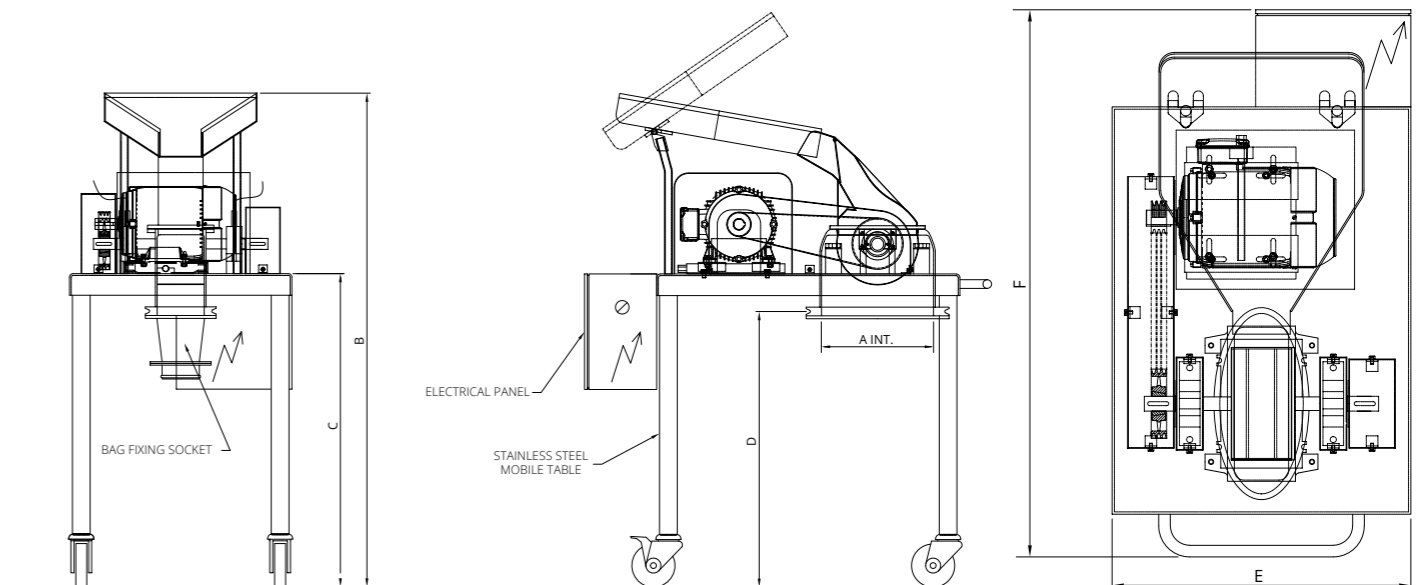

## Technical Data

Model	Power kW	Dimensions (mm)					
		A int.	B	C	D	E	F
<b>MPS-115</b>	2.2	130 x 300	1,590	1,030	915	760	1,380
<b>MPS-310</b>	5.5	140 x 394	1,690	1,065	920	770	1,410
<b>MPS-420</b>	11/22	330 x 394	1,690	1,065	920	1,075	1,350